



Mini Volume Pedal Owner's Manual

Thanks for purchasing the DOD® Mini Volume Pedal, the miniature passive volume pedal that gives you a full range of volume control, without robbing you of valuable pedalboard space.

Features:

- Small form factor occupies minimal pedalboard space
- Long-throw treadle for full range of control
- High-quality, high-cycle 500kΩ potentiometer for smooth volume adjustments
- Built-in treble bleed circuit prevents loss of treble at lower volume settings
- Removable rubber feet for pedalboard mounting
- 1/4" TS input and output jacks
- Skid-free treadle pad
- Rugged construction

Setup:

1. Turn your amp off, then connect your cables (see connection diagram below).
2. Turn your amp volume down, push the DOD Mini Volume Pedal's treadle toe down, then turn your amp on.
3. Slowly raise your amp volume until the desired level is reached.

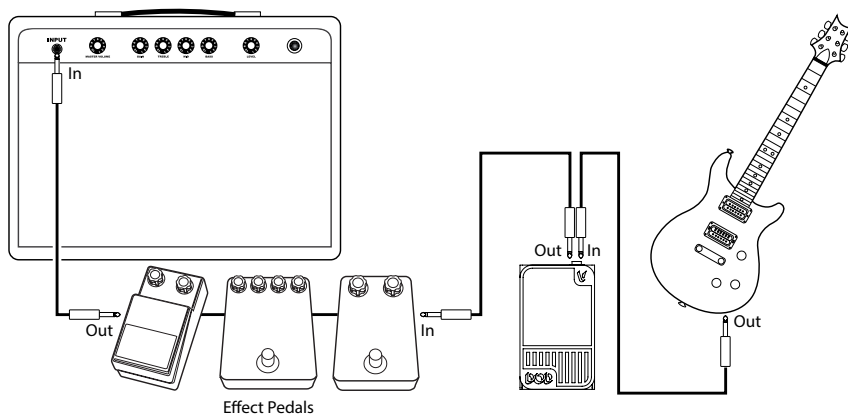

Use only unbalanced TS cables.

****IMPORTANT USAGE NOTE****

The two hex screws on the bottom of the pedal are part of a spring-loaded adjustment mechanism. If over time you experience slop, loosen these screws slightly and then re-tighten. This will cause the main engagement gear to re-tighten against the treadle gear.

DO NOT remove these screws or operate the treadle while the screws are loosened. This can cause the gears to become misaligned and cause the pedal to malfunction. **There are no user-adjustable components inside the pedal. Under no circumstances should the pedal be opened up.**

DECLARATION OF CONFORMITY

Manufacturer's Name: DOD
Manufacturer's Address: 10653 South River Front Parkway, #300
South Jordan, Utah 84095, USA

Declares that the product:

Product name: DOD Mini-Volume
Product option: None

Conforms to the following Product Specifications:

Safety: N/A – no power
EMC: Analog Products

The DOD Mini-Volume and Mini-Expression pedals by design provide an adequate level of intrinsic immunity as called out in EN55024. By following good engineering practices and engineering rational Harman declares that by design these pedals will provide an adequate level of intrinsic immunity and will operate as intended in their environment.

Supplementary Information:

The product herewith complies with the requirements of the:
Low Voltage Directive 2006/95/EC
EMC Directive 2004/108/EC
RoHS Directive 2011/65/EC
WEEE Directive 2002/96/EC
EC Regulation 278/2009

C. Rex Reed
Director, Engineering
Signal Processing
10653 South River Front Parkway, #300
South Jordan, Utah 84095, USA
Date: June 26, 2017

European Contact: Your local DigiTech Sales and Service Office or

Harman Signal Processing
10653 South River Front Parkway, #300
South Jordan, Utah 84095, USA
Ph: (801) 566-8800
Fax: (801) 568-7583

DÉCLARATION DE CONFORMITÉ

Nom du fabricant : DOD
Adresse du fabricant : 10653 South River Front Parkway, #300
South Jordan, Utah 84095, ÉTATS-UNIS

déclare que le produit :

Nom du produit : DOD Mini-Volume
Option du produit : Aucune

est conforme aux spécifications suivantes :

Sécurité : S/O – sans pouvoir
CEM : Produits Analogiques

Les pédales DOD Mini-Volume et Mini-Expression par conception fournissent un niveau adéquat d'immunité intrinsèque tel qu'indiqué dans EN55024. En suivant les bonnes pratiques d'ingénierie et l'ingénierie rationnelle, Harman déclare que, grâce à la conception, ces pédales fourniront un niveau adéquat d'immunité intrinsèque et fonctionneront comme prévu dans leur environnement.

Informations complémentaires :

Ce produit est conforme aux exigences suivantes :
Directive sur la basse tension 2006/95/CE
Directive CEM 2004/108/CE
Directive RoHS 2011/65/CE
Directive DEEE 2002/96/CE
Règlement 278/2009 de l'CE

C. Rex Reed
Directeur, Ingénierie
Traitement des signaux
10653 South River Front Parkway, #300
South Jordan, Utah 84095, ÉTATS-UNIS
Date : 26 juin 2017

Contact en Europe : Votre bureau local de vente et de service DigiTech ou

Harman Signal Processing
10653 South River Front Parkway, #300
South Jordan, Utah 84095, ÉTATS-UNIS
Tél. : (801) 566-8800
Fax : (801) 568-7583